



10. - 12. 7. 2015

Rally Championship of the Czech Republic
Regional Rally Cup



Mladá Boleslav



SUPPLEMENTARY REGULATIONS



rallybohemia.cz



Foto: Škoda Auto

generální partner:



ŠKODA



NOPROSU





SUPPLEMENTARY REGULATIONS

RALLY BOHEMIA

10th – 12th July 2015

Rally Championship of the Czech Republic

Regional Rally Cup

Content

1	INTRODUCTION	2
2	ORGANIZATION AND DESCRIPTION	2
3	PROGRAMME	5
4	ENTRIES	6
5	INSURANCE	10
6	ADVERTISING AND IDENTIFICATION	11
7	TYRES	12
8	FUEL	12
9	RECONNAISSANCE	13
10	ADMINISTRATIVE CHECKS	15
11	SCRUTINEERING, SEALING, MARKING	15
12	OTHER PROCEDURES	18
13	OFFICIALS IDENTIFICATION	22
14	CLASSIFICATION AND PRIZES	22
15	FINAL CHECKS AND PROTESTS	24
	APPENDIX 1: SCHEDULE	25
	APPENDIX 2: RECONNAISSANCE SCHEDULE	27
	APPENDIX 3: COMPETITORS' RELATIONS OFFICERS	28
	APPENDIX 4: START NUMBERS AND ADVERTISEMENT	29
	APPENDIX 5: DRIVERS' SAFETY EQUIPMENT REGULATION	30
	APPENDIX 6: GPS ONI® TRACKING SYSTEM	31



Autoklub Bohemia Sport v AČR
Sosnová 200, 470 01 Česká Lípa
IČ: 75057930, reg. č. 1558





1 INTRODUCTION

1.1 General

The 42nd Rally Bohemia will run in compliance with the FIA International Sporting Code (hereinafter FIA ISC) and its appendices, the FIA Regional Rally Championship Regulations 2015 (hereinafter FIA RRSR), the National Sporting Regulations which complies with the FIA regulations and these Supplementary Regulations.

Modifications, amendments and/or changes to these Supplementary Regulations will be announced only by numbered and dated Bulletins (issued by the organizer or Stewards). Additional information will be published in the Rally Guide, issued on 8th June 2015 at www.rallybohemia.cz. The FIA Regional Rally Championship Regulations are available for download on internet website at www.fia.com. The National Sporting Regulations and Supplementary Regulations can be downloaded from the official web pages www.autoklub.cz.

1.2 Road surface

100 % asphalt

1.3 Track

Total distance of special stages: 151.65 km
Total distance of the rally: 458.86 km

2 ORGANIZATION AND DESCRIPTION

2.1 Rally Inclusion

Rally Championship of the Czech Republic 2015
Regional Rally Cup
Junior Champion of CR
Ladies Cup of CR

2.2 Visa Numbers

ASN Visa number: **AR00415** of **20th May 2015**

2.3 Organizer's Contact Details

Autoklub Bohemia Sport v AČR
Sosnová 200, 470 01 Česká Lípa, Czech Republic
Phone: +420 487 874 805
Email: informace@rallybohemia.cz
Web: www.rallybohemia.cz



Autoklub Bohemia Sport v AČR
Sosnová 200, 470 01 Česká Lípa
IČ: 75057930, reg. č. 1558





Banking details: KB Česká Lípa

Domestic payments

Account number: 107-6696580257/0100
IBAN: CZ2601000001076696580257
BIC: KOMBCZPPXXX

Payments from abroad

Account number: 107-9826970207/0100
IBAN: CZ0801000001079826970207
BIC: KOMBCZPPXXX

2.4 Organization Committee

Chairman: Pavel DUŠÁNEK

Members: Petr ELIÁŠ, Bronislav MOCEK, Petr PAVLÁT, Jan ŠRÁMEK, Jan PEŠKAŘ,
Viktor TRNKA

2.5 Sports Marshals

Chief Sports Marshal:	Mr. Tomáš KUNC	CZE
Sports Marshals:	Mr. Antonín BERGER	CZE
	Mr. Josef VRÁTIL	CZE

2.6 Observers and Delegates

ASN Safety delegate:	Mr. Miroslav Smolík	CZE
----------------------	---------------------	-----

2.7 Senior officials

Clerk of the Course:	Mr. Petr PAVLÁT	
Deputy COC:	Mr. Pavel DUŠÁNEK	
Deputy COC:	Mr. Petr ELIÁŠ	
Chief Scrutineer:	Mr. Josef STRÁNSKÝ	
RRC Scrutineer:	Mr. Carl Ulrich KARSTEN	D
RRC Scrutineer:	Mr. Dariusz SWIES	PL
Chief Timekeeper:	Mr. Ladislav JUST	
Chief Controller:	Mr. Pavel ŠTÍPEK	
Competitors' Relations Officer:	Mr. Pavel KONEČNÝ	
Competitors' Relations Officer:	Mr. Zdeněk BĚLÁK	
Competitors' Relations Officer:	Mr. Jakub HOFBAUER	
Chief Safety Officer:	Mr. Jan ŠRÁMEK	
Steward's Secretary	Mr. Jiří VENUŠ	
Press Relations Officer:	Mr. Aleš HOLAKOVSKÝ	
Monitoring system ONI:	Mr. Václav ŠTÍPEK, SAS Zlín	
Chief Medical Officer:	Ms. Ivana ŽYKOVÁ, M.D.	
Deputy Chief Medical Officer:	Ms. Lucie ŽIHLOVÁ, M.D.	
Results Processing:	RECO, Mr. Lubomír ŠPERKA	



Autoklub Bohemia Sport v AČR
Sosnová 200, 470 01 Česká Lípa
IČ: 75057930, reg. č. 1558





2.8 Headquarters Location

Place: Mladá Boleslav, Dům kultury, ul. Dukelská 1093

Date:	9 th July 2015	Time:	14:00 – 22:00
	10 th July 2015		07:00 – 23:00
	11 th July 2015		07:00 – 02:00
	12 th July 2015		07:00 – 19:00

2.9 Press Centre Location

Place: Mladá Boleslav, Dům kultury, ul. Dukelská 1093

Date:	10 th July 2015	Time:	16:00 – 23:00
	11 th July 2015		07:30 – 01:40
	12 th July 2015		07:30 – 18:30

2.10 Closed Parking Place Location

Place: Leg 1 – Mladá Boleslav, 11th Gate Škoda Auto

Place: At the rally finish – Mladá Boleslav, Staroměstské náměstí

2.11 Service Park Location

Place: Mladá Boleslav, 11th Gate Škoda Auto

2.12 Notice Boards

Official notice board

Place: Mladá Boleslav, Rally Bohemia HQ

Date:	9 th July 2015	Time:	14:00 – 22:00
	10 th July 2015		07:00 – 23:00
	11 th July 2015		07:00 – 02:00
	12 th July 2015		07:00 – 19:00

Information notice board

Place: Mladá Boleslav, 11th Gate Škoda Auto

Date:	10 th July 2015	Time:	18:00 – 23:00
	11 th July 2015		07:00 – 02:00
	12 th July 2015		07:00 – 19:00



Autoklub Bohemia Sport v AČR
Sosnová 200, 470 01 Česká Lípa
IČ: 75057930, reg. č. 1558





3 PROGRAMME

Before the rally

Monday 11 th May 2015		
	Publishing of Supplementary Regulations	www.rallybohemia.cz
Monday 8 th June 2015		
	Rally Guide Issue	www.rallybohemia.cz
Friday 26 th June 2015		
18:00	Closing date for entries and shakedown registration	Rally HQ, Dům kultury MB
	Publishing of SS maps	www.rallybohemia.cz
Thursday 2 nd July 2015		
18:00	Closure of extra services at the Service Park	servis@rallybohemia.cz
Friday 3 rd July 2015		
	Publishing of the list of entries	www.rallybohemia.cz

During the rally

Thursday 9 th July 2015		
15:00 - 19:00	Issuing of the Road Book, ONI System for Recce, Administrative Check	Rally Bohemia HQ, MB
17:45 - 22:00	Reconnaissance SS Sychrov, Šumburk, Bzí, Lobeč, Vinec, Shakedown	According to Appendix 2
21:45 - 01:00	Reconnaissance SS Staroměstská and Bondy	According to Appendix 2
Friday 10 th July 2015		
8:00 - 18:00	Reconnaissance SS Sychrov, Šumburk, Bzí, Lobeč, Vinec, Shakedown	According to Appendix 2
16:00	Opening of Press Centre and Media accreditation	Rally Bohemia HQ, MB
18:00	Opening of Service Park	Mladá Boleslav, 11 th Gate Škoda Auto
18:00 - 19:30	Administrative Check	Rally Bohemia HQ, MB
19:30	Co-driver Information Completion	Rally Bohemia HQ, MB
21:00 - 22:00	Ceremonial start, Press conference, Autograph session	Mladá Boleslav, Staroměstské náměstí
Saturday 11 th July 2015		
7:00 - 11:00	Scrutineering, Reconnaissance ONI system returning	Mladá Boleslav, 11 th Gate Škoda Auto
9:30 - 12:00	Shakedown - Start numbers 1 - 20	Hrdlořezy
10:00 - 12:30	Shakedown - the others	Hrdlořezy
11:30	First Stewards' meeting	Rally Bohemia HQ, MB
12:30	Publication of Start list for Leg 1	Rally Bohemia HQ, MB
14:55	Rally start	Mladá Boleslav, 7 th Gate Škoda Auto
15:00	Start SS Bondy	Mladá Boleslav, 7 th Gate Škoda Auto
13:30	Accompanying programme of SS Bondy	Mladá Boleslav, Škoda Auto Museum
Sunday 12 th July 2015		
0:00	Closing of announcement of new Start in Leg 2	Rally Bohemia HQ, MB
1:40	Finish of Leg 1	Parc Fermé, 11 th Gate Škoda Auto
7:30	Publication of Start list for Leg 2	Rally Bohemia HQ, MB
9:15	Start of Leg 2	Mladá Boleslav, 11 th Gate Škoda Auto
14:21	Finish of the Rally	Mladá Boleslav, Old Town Square
14:45	Prize Awarding Ceremony in Finish	Mladá Boleslav, Old Town Square
14:55	Press Conference	Mladá Boleslav, Old Town Square
15:10	Final scrutineering	Škoda Auto Customer Centre, Mladá Boleslav
16:15	Publication of Provisional Final Classification	Rally Bohemia HQ, MB
16:45	Publication of Official Final Classification	Rally Bohemia HQ, MB



Autoklub Bohemia Sport v AČR
 Sosnová 200, 470 01 Česká Lípa
 IČ: 75057930, reg. č. 1558





4 ENTRIES

4.1 Closing Date for Entries

26th June 2015 at 18:00, Mladá Boleslav

4.2 Entry Procedure

4.2.1 Registration Options

All Rally Bohemia applicants have to apply properly before the registration closure. They can choose either the electronic registration form or sending the registration form via surface mail.

4.2.2 Electronic Registration Form

The possibility of online registration with the help of a properly completed e-form at the competition web sites www.rallybohemia.cz. The determining figure when registering online is the date and time of sending the web form. After making the online registration, the competitor has to print the entry, and then at the administrative check, they will hand this original signed by the competitor and both drivers over to the organizer.

4.2.3 Surface Mail Registration

When registering via paper registration form, it has to be fully completed and sent to the Rally Secretariat (for address details see paragraph 2.3). The decisive data when submitting the entry application is the date and time of its delivery to the Rally Secretariat.

4.2.4 Additional Information

Details about co-driver can be delivered additionally (see point 3).

4.2.5 Payment

The registration will be valid only when the whole amount is paid out. The organizer reserves the right to exceptionally accept the entry form before payment. Late payment is possible only after a prior agreement with the organizer, and it always involves payment increase by 25%. In such a case the competitor is obliged to pay it by the time of the itinerary receipt at the latest.

4.2.6 Registration Confirmation

All registrations will be confirmed via email message. The registration status can be checked also online at www.rallybohemia.cz.

4.3 Number of Competitors Accepted and Classes

4.3.1 Number of Accepted Entry Forms

The maximum number of entrants is fixed at 80.



Autoklub Bohemia Sport v AČR
Sosnová 200, 470 01 Česká Lípa
IČ: 75057930, reg. č. 1558





4.3.2 Eligible Groups and Classes of rally Championship of CR

Only those cars complying with the provisions of Appendix J of the FIA ISC and of the Article 11.3 to 11.6 of these SR may take part in the rally. Using the FIA approved frontal head restraint (FHR) is obligatory for all drivers and co-drivers.

Class	Groups
2	S2000-Rally: 1.6 turbo w/ restrictor 30 mm (RRC) S2000-Rally: 2.0 atmospheric (S2000 atm) R4 R5
3	N over 2000 cm ³
4	RGT cars, Porsche GT
5	A over 1600 cm ³ up to 2000 cm ³ Super 1600 R2C (over 1600 cm ³ to 2000 cm ³) R2C (turbo over 1067 cm ³ to 333 cm ³) R3C (atmo over 1600 cm ³ to 2000 cm ³) R3C (turbo over 1067 cm ³ to 1333 cm ³) R3T (up to 1620 cm ³ / nominal)
6	A over 1400 cm ³ up to 1600 cm ³ R2B (atmo over 1390 cm ³ up to 1600 cm ³) R2B (turbo over 927 cm ³ up to 1067 cm ³) Kit-car over 1400 cm ³ to 1600 cm ³
7	A up to 1400 cm ³ Kit-car up to 1400 cm ³
8	N over 1600 cm ³ up to 2000 cm ³
9	N above 1400 cm ³ up to 1600 cm ³ R1B (atmo over 1390 cm ³ up to 1600 cm ³) R1B (turbo over 927 cm ³ to 1067 cm ³)
10	N up to 1400 cm ³ R1A (atmo up to 1390 cm ³) R1A (turbo to 927 cm ³)
11	A or B with turbo charged engine Diesel up to 2000 cm ³ /nominal R3D (to 2000 cm ³ / nominal)
12	S to 2000 cm ³ including Kit Cars
13	S above 2000 cm ³

Specification

- The cars homologated as "Kit Cars", where the capacity is between 1400 and 1600 cm³, may be accepted should they also comply with the Article 255.6.2 "Weight" of the Appendix J.
- Two-wheel drive cars equipped with a supercharged Diesel engine with a nominal cylinder capacity of less than 2000 cm³ are allowed in A and N Groups.
- For cars homologated as S1600 and S2000 it is possible to use lapsed extensions without any penalty.



Autoklub Bohemia Sport v AČR
Sosnová 200, 470 01 Česká Lípa
IČ: 75057930, reg. č. 1558





- Cars R3D included in class 11
- S class cars (national) are allowed:
 - o Cars "Kit car" with volume above 1600 cm³.
 - o Cars A8 including WRC according to Article 255 of Appendix J of the FIA ISC 2006 with the homologation date for WRC group (WR variant) until 2006 incl., however, with safety elements and weight in compliance with current valid regulations, which was tested in the Czech Republic, and with Czech registration plate issued by the end of 2014.
 - o Then cars with FIA basic expired homologation (homologations valid since **1. 1. 1987**) with the possibility of maximum customizations for class A, but with safety elements and weight according to the currently valid regulations.
- Cars with national homologation are allowed.

4.3.3

RRC cars complying with the classes according to point 4.3.2 will be included in the main field of the Championship of the Czech Republic.

4.3.4

Cars corresponding to some class listed by the national ASN of the country organizing RRC Cup can take part in the RRC Cup. These cars will go at the end of the starting field of the Czech Republic Rally Championship.

4.4 Entry Fee / Entry Packages

4.4.1 Entry Fee

4.4.1.1

Basic fee - closing date on Friday 26th June 2015

The fee with optional advertisement offered by the organizer:
CZK 13,100 + insurance CZK 1900 = CZK 15,000 / € 550

Entry fee without optional advertising
CZK 26,200 + CZK 1,900 (insurance) = CZK 28,100 / € 1,040

4.4.1.2

The fee settled after the entry forms closing date (from 27.6. to 8.7.2015)

The fee with optional advertisement offered by the organizer:
CZK 16,375 + insurance CZK 1,900 = CZK 18,275 / € 670

The fee without the organizer's advertisement:
CZK 32,750 + insurance CZK 1,900 = CZK 34,650 / € 1,280



Autoklub Bohemia Sport v AČR
Sosnová 200, 470 01 Česká Lípa
IČ: 75057930, reg. č. 1558





4.4.2 Entry Package

Printed material	Amount
Supplementary Regulations	www.rallybohemia.cz
Rally Guide	www.rallybohemia.cz
Rally Itinerary	1
Service Itinerary	1
Rally Programme	www.rallybohemia.cz
Label Persons	Pieces
Driver	2
Service	4
Label Car	Pieces
Reconnaissance Car	1
Service A	1
Service B	1
Racing Car	1

4.5 Payment Details

By means of postal money-order to the address of the organizer or via bank transfer (for account details see paragraph no 2.3). Foreign crews shall pay the entry fee in EUR to the foreign currency account. The driver's licence number is used as the variable symbol. The payment receipt or declaration of the payment must be sent to the organizer together with the completed entry form.

4.6 Entry Fee Refund

The whole entry fee will be refunded in full if:

- Entry form has not been accepted
- Rally has been cancelled
- Registration is cancelled by the entrant before the closing date for entries

The organizer will refund 80% of the entry fee to those competitors who will inform about their absence before the start of reconnaissance in writing. The crews excused in writing before the administrative check will be refunded 50% of the entry fee.

Should the registered crew fail to excuse themselves from the participation in the rally in writing, the refund will be rejected.



Autoklub Bohemia Sport v AČR
 Sosnová 200, 470 01 Česká Lípa
 IČ: 75057930, reg. č. 1558





5 INSURANCE

5.1 Insurance Coverage for the Organizer

5.1.1

The Autoklub ČR has made the insurance contract with Česká podnikatelská pojišťovna, a.s., Vienna Insurance Group Company through the RENOMIA a.s. Company, a framework agreement No. 0013875833, organizer's liability insurance covering damage caused to the third party during the competition up to CZK 10,000,000 per event.

5.1.2

The part of the insurance agreement no. 0013875833 made between Česká podnikatelská pojišťovna a.s. – Vienna Insurance Group and the Autoklub of the Czech Republic is the coverage for cars against the damage caused to third party up to CZK 10,000,000 per participant. However the damage caused by drivers among themselves is not covered by this contract.

The organizer undertakes to arrange this insurance contract for all competitors except those, who will document at the administrative check the long-term liability insurance covering damage caused on closed track.

The insurance premium at CZK 1,900 will be collected from participants by the organizer at the same time together with the entry fee.

5.1.3

The insurance of organizers and participants is made with an integral excess of CZK 5,000. It means that damage up to CZK 5,000 won't be refunded and damage above CZK 5,000 will be covered without the participation of insured.

5.1.4

All crews at administrative check have to hand in the valid International Green Card for their car. Without this card the crew won't be permitted to start.

5.2 Insurance Coverage of the competitors and crews

5.2.1

All the drivers and co-drivers are obliged to arrange their own accident insurance. The proof should be documented on request at administrative check - ACR licence also contains accident insurance. The insurance of foreign crews shall include coverage of the costs of possible medical treatment in the Czech Republic.



Autoklub Bohemia Sport v AČR
Sosnová 200, 470 01 Česká Lípa
IČ: 75057930, reg. č. 1558





5.2.2

Both the crew members will submit their health insurance company card at the administrative check.

5.3 Damage Reporting

The crews are obliged to notify the organizer about the damage caused on the track by their car by the end of event the latest. Violation of this duty stands for summoning the competitor and involved crew to a disciplinary committee.

5.4 Insurance Coverage Exclusions

Auxiliary vehicles, cars dedicated to reconnaissance and vehicles with special labels issued by the organizer are not covered by the provided rally insurance (with the exception of insured organizer's cars) and they always act on their own responsibility.

6 ADVERTISING AND IDENTIFICATION

6.1 Compulsory Advertising

A – On rally plates - shield RALLY BOHEMIA
B – On competition numbers RALLY BOHEMIA

6.2 Optional Advertising Offered by the Organizer

C – Optional Advertising ŠKODA, GLOBAL ASSISTANCE, MOGUL

The competitors who will accept the organizer's optional advertising shall reserve space of 67 x 20 cm on both front doors for its placement.

6.3 Competition Numbers and Rally Plates

The organizer will provide each crew with competition numbers and rally plates on collection of the itineraries. All numbers and plates (including the advertising) must be placed in the stated manner before scrutineering (see the Appendix No. 4 of these SR). The name plates on the rear side windows have to correspond to SPR, Article 19.

6.4 Loss or Removal of Advertising and Labels

6.4.1

Should the advertising be found missing on the car during rally or amended or transferred (article 6.1 and 6.2 SR), the penalty at the proportional amount to the entry fee, minimum 20%, though, will be imposed to the crew by the Clerk of the Course.



Autoklub Bohemia Sport v AČR
Sosnová 200, 470 01 Česká Lípa
IČ: 75057930, reg. č. 1558





6.4.2 Loss or Removal Penalties

If it is missing at any time during the rally that:

- One competition number or rally plate; penalty of CZK 3,000 / € 110 will be imposed on the crew by the Clerk of the Course.
- Two competition numbers on front doors; notice to the Stewards.
- Driver's and/or co-driver's name; penalty of CZK 1,000 / € 35 will be imposed on the crew by the Clerk of the Course.

7 TYRES

7.1 Public Roads

When driving the car on public roads in the Czech Republic, the depth of the tyre tread pattern must be min. 1.6 mm. Moulded tyres shall only be used when approved for the use in traffic having the "E" homologation or tyres that are in conformity with Article 60 of SPR. For the Rally Championship of the Czech Republic only Article 60 of SPR is applied.

7.2 Reconnaissance

During the reconnaissance only the tyres approved for use in traffic shall be used.

7.3 Tyres Temperature

Measuring the tyres temperature in a distance of 100 m behind STOP sign is not considered an outside assistance if it is conducted by the representatives of tyre companies registered at the organizer.

7.4 Sanctions

Any breach of the tyre regulations will be reported to the Stewards.

7.5 Hand Cutting

Hand cutting is allowed only in Service Park.

8 FUEL

Unleaded fuel with a maximum lead content of 0.013 g/l is permitted only.



Autoklub Bohemia Sport v AČR
Sosnová 200, 470 01 Česká Lípa
IČ: 75057930, reg. č. 1558





9 RECONNAISSANCE

9.1 Reconnaissance Registration Procedure

When receiving itinerary each crew must announce to the organizer the registration number and the car make to be used for the reconnaissance. The organizer will supply the crew with starting number identification which must be affixed in the right upper corner of the windscreen and on rear side windows. After finishing the reconnaissance the numerical marking has to be removed from the car, the basic identification for reconnaissance can be used for parking in the parking space next to the service park. Only the cars, specified in the SPR are allowed for reconnaissance and they must be insured according to law.

The crew must announce any change of the reconnaissance car to the Clerk of the Course (Mr. Petr Pavlát +420 605 168 331) in advance.

9.2 Reconnaissance Rules

Reconnaissance schedule can be found in the Appendix No. 2 of hereby SR.

9.2.1 Reconnaissance before Allowed Date

In case of the crew (driver and / or co-driver) makes the reconnaissance on the tracks of special stages before the closing date for entries, it will be refused by the Organization Committee to participate. If a crew carry out the reconnaissance after closing date outside the official reconnaissance schedule, the Clerk of the Course will reject their start in the competition and the registration fee won't be refunded.

9.2.2 Reconnaissance before the Competition

Any presence of a racing or any other team's car on the SS track during 2 months before the start of the rally is strictly forbidden (except the reconnaissance car during the recce). Violating this rule shall result in entry refusal.

9.2.3 Reconnaissance Passages

During the reconnaissance max. 3 passages are allowed on the same special stage. Driving in reverse direction of the special stage is forbidden unless stated otherwise in the documents on reconnaissance. The crews are obliged to obey all the SPR regulations and herewith the Supplementary Regulations about reconnaissance.

9.2.4 Checks

Marshals at the start and stop points and also throughout every special stage will observe the progress of reconnaissance. In this case these points will be marked with standard signs with red background. Other checks may be inside a special stage check. If there are Marshals on the points, the crews must stop their car at these panels, and follow the instructions of Marshals. The crews can drive in and out the special stage only through the start and finish checks.



Autoklub Bohemia Sport v AČR
Sosnová 200, 470 01 Česká Lípa
IČ: 75057930, reg. č. 1558





The Judges of Fact authorized by the Clerk of the Course will provide random checks during the reconnaissance. Their list will be published on the official notice board.

9.2.5 Speed Limits Monitoring

Maximum speed limits during the reconnaissance follow the Czech traffic regulations and those are mentioned in the Road Book. Progress of the recce will be monitored via ONI® System. Violating the traffic rules and mainly exceeding the speed limits will be checked by the monitoring device ONI® System as well as by the Police of Czech Republic. Any violations will be dealt and fined by the Police of the Czech Republic according to standard procedures. ONI® System monitors the speed information online continuously during the recce.

All crews will pick up ONI® System monitoring device together with Road Book. The device shall be returned to the organizer at scrutineering. Its installation and usage during recce is compulsory for every crew in accordance with Article No. 3 Programme. Failure to use it will result in penalization. 12V DC supply with cigarette lighter socket is needed for the system functioning. The system will be handed out against driver's licence. The late return of the unit will be penalized by the amount CZK 1,000. The unit loss will be penalized by the amount CZK 2,400 excl. VAT.

Every attempt to falsify, manipulate or otherwise interfere with the monitoring device assigned to the recce car, or any other device blocking to record data will be reported to the sports chiefs who can impose penalties up to the refusing of start.

Valuating the seriousness of the offence and its recurrence is under the decision of the Clerk of the Course.

Exceeding speed limits shall result in penalties in accordance with Article 20.2 of SR.

All crews will return ONI® System monitoring devices to the Organizer during Technical scrutineering.

9.2.6 Other Rules

The competitors who will fail to obey other rules, will be liable to a fine, time penalty or start refusal according to the decision of Stewards.

9.2.7 Tracks Remarks of the Crews

Place: Mladá Boleslav, Rally Bohemia HQ
Date: 11th July 2015 Time: 8:00 – 9:00
Officer: Petr Pavlát – Clerk of the Course (phone +420 605 168 331)



Autoklub Bohemia Sport v AČR
Sosnová 200, 470 01 Česká Lípa
IČ: 75057930, reg. č. 1558





10 ADMINISTRATIVE CHECKS

10.1 Documents to be presented

By administrative check every crew will submit:

- Competitor's and driver's licences
- ASN authorisation to start and accident insurance policy (only foreign competitors)
- Driver's and co-driver's medical health insurance cards
- Driving licences of both crew members
- Driver's and co-driver's passports or other identification documents
- Car registration document
- Authorization by the owner of the car should it be the third person
- Car insurance (Green card of the car)
- Technical card

If the crew sent both-side copies scanned of all documents as attachments with the entry form, submitting drivers' licences, driving licences and green card will do at the administrative check.

10.2 Place and Timetable

See paragraph no. 3 PROGRAMME.

11 SCRUTINEERING, SEALING, MARKING

11.1 Place and Timetable

See paragraph no. 3 PROGRAMME

11.1.1 Scrutineering Time

Exact time of the scrutineering of each car will be specified in the organizer's web sites www.rallybohemia.cz and it will be sent to the crews together with the technical card electronically. It will also be available during the administrative check. Keeping to the scrutineering time will be monitored by TC situated at the entrance of the scrutineering space.

11.1.2 Late Arrival and Sanctions

Registered car can be put to the scrutineering and sealing by the competitor representative. Late arrival to the time check controls will be penalised by the Clerk of the Course by CZK 1,000 / € 35 for every completed 5 minutes of delay. A delay longer than 30 minutes will be reported to the Stewards.



Autoklub Bohemia Sport v AČR
Sosnová 200, 470 01 Česká Lípa
IČ: 75057930, reg. č. 1558





11.1.3 Documents to be checked

During the scrutineering all competitors hand in:

- Homologation papers of the car, sports certificate of the car (when specified)
- Technical card, safety equipment card of the driver and the co-driver, all filled in
- Other documents specified in the technical regulations

11.2 Sealing

Paragraph 63 of SR only applies to compressors.

Sealing of gear will not be made, competitor's obligation to inform the chief technician about the intention to change the gear / differential is not cancelled.

11.3 Tinted Windows

In compliance with the paragraph no. 253.11, Appendix J of the FIA ISC regulations it is allowed to use silvered or tinted films on the side and rear windows and on the glassed sunroof under the following condition – transparency of these films must allow an outside standing person to see the crew as well as the interior of the car.

11.4 Safety Equipment of the Crew

Every competitor has to bring the complete set of clothes, which will be used, including helmets and a FIA approved frontal head restraint (FHR) and documents of safety equipment filled out. The conformity with Chapter III of the Appendix L of the FIA ISC and with technical NSR regulations will be checked (see the Appendix no. 5 of hereby SR).

11.5 Noise Level

All cars must be equipped with stable exhaust silencer. External noise level and its measuring must comply with NSR Chapter E paragraph 7 and SR item 4.5.2.

Noise level will be measured during the scrutineering and/or during the event. Any car exceeding the permitted noise level at the scrutineering will not be permitted to start. Any excessive noise level detected during the event will be reported to the Stewards.

11.6 National Technical Regulations

All vehicles must comply with the Czech law no. 56/2001 with relevant exceptions for sports cars. At the scrutineering each competitor shall submit:

- car homologation certificate, sports certificate (if needed),
- technical card including the driver and co-drive safety equipment card completed,
- other documents set by the technical regulations.



Autoklub Bohemia Sport v AČR
Sosnová 200, 470 01 Česká Lípa
IČ: 75057930, reg. č. 1558





11.6.1 Exhaust Catalysts

All cars must be equipped obligatorily with an efficient homologated exhaust catalytic converter. Its efficiency set, emission limits and the way of measuring is described in NSR, Chapter E paragraph 8.

Should there be the catalyst missing or incomplete on a car at scrutineering the crew will not be permitted to start. Should this happen during the event the car will be reported to the Stewards.

11.6.2 Car Lights

It is forbidden to drive with additional searchlights without homologation E switched on during road sections. Non-compliance will be reported to the Stewards.

11.7 Obligatory ONI® Monitoring System

11.7.1

Details are given in the Appendix no. 6 of hereby SR.

11.7.2

The cars not equipped by the ONI® System monitoring device are not allowed to start.

11.7.3

Any attempt to tamper with, to manipulate or to interfere with the tracking device fitted to competition car or any device that fails to record tracking due to an external interference, will be reported to the Stewards, who may impose a penalty up to exclusion.

Possible destroying, failing to return or damaging the device a competitor has to make payment according to approved price list.

11.7.4 Rent Fees

Monitoring device	CZK	100
Device holder (new)	CZK	300
Complete set of the mobile unit (for foreigners)	EUR	15
Refundable deposit for ONI® Administrator	CZK	1000 or licence



Autoklub Bohemia Sport v AČR
Sosnová 200, 470 01 Česká Lípa
IČ: 75057930, reg. č. 1558





12 OTHER PROCEDURES

12.1 Starting Procedures and Starting Order

12.1.1 Start of the Rally

The official start of the rally will be at TC Mladá Boleslav. The crews will arrive at TC 1 according to the schedule given. There the crews will receive a racing sheet for the first section of Leg 1. When the delay is longer than 15 minutes, the crew will not be allowed to start in Leg 1 (Article 44 of SR).

12.1.2 Ceremonial Start

Selected crews in overalls and with their racing cars will participate in the ceremonial start. The ceremonial start timing will be announced at the administrative check and it will be at www.rallybohemia.cz as well. The crew that will not attend the ceremonial start may be penalized with up to CZK 5,000 / € 185.

12.1.3 Restart after Retirement

The competing car which fails to finish leg 1 is permitted to restart the next leg. The conditions for a new start mentioned in the paragraph No. 46 of SR have to be met. The competitor will directly inform the clerk of the course about their intention to continue in the following leg, or through his officers for relations with competitors by 0:00 o'clock on 12th July 2015 (see Article 3 of PROGRAMME).

After the repair and prior the restart into the leg 2 the car has to pass the inspection done in Parc Fermé – 12th July 2015 at 08:00.

12.1.4 Starting System for the Special Stages (except SS1)

Start will be performed with the help of a digital starting clock (countdown system) connected to a photocell detecting early starts. Start line is fixed and the car has to be positioned according to the starter's instructions, namely that its front part aligns the start line.

Starting procedure:

- 39 seconds - red light switches on
- 30 seconds - starter points at the countdown system
- 10 seconds - red light blinks
- START - green light switches on
- 20 seconds - green light switches off and red light switches on and Art. 37.4.3 of SR applies



Autoklub Bohemia Sport v AČR
 Sosnová 200, 470 01 Česká Lípa
 IČ: 75057930, reg. č. 1558





12.1.5 Starting System for the Super Special Stage 1 Bondy

The timekeeper – starter takes record of the crews' start time to SS in the pre-start space. It will be the beginning of the running time for the next TC. The entry to SS will be made on the organizer's instruction with respect to the drivers' safety. After leaving the pre-start space, the crew will pass the flying start onto the SS track. The interval of 20 seconds for starting is checked by the timekeeper. Apart from the flying start, SS has the character of a standard SS.

12.1.6

SPR regulations are applied to the cases not mentioned here.

12.2 Ceremony at the Finish

The competition track finishes at TC 13A point in the entrance of the holding area in front of the finish ramp where the crews will be awarded with prizes according to Art.14.2 of SR. After the ceremony all crews have to drive directly to the Parc Fermé of finish.

12.3 Permitted Early Arrival

Early arrival at Regrouping (TC 1A) is permitted.

Early arrival at the Parc Fermé at the end of leg 1 (TC 7C) is permitted.

Early arrival at the finish of the rally (TC 13A) is permitted.

12.4 Special Stages

12.4.1 Barriers

For safety reasons the barriers will be placed on the rally track. The list of the Judges of Fact will be published at the official notice board.

Incorrect barrier passage will be penalised by the Clerk of the Course as follows:

5 seconds - Any, even partial, move or flip over of the barrier out of the marked base on the road

20 seconds - Drive through (any even a partial move or flip over of more than one part of the barrier - bale out of the marked base on the road) or passing the barrier partly

30 seconds - Not passing (avoiding) the barrier

Questionable cases will be decided by the Stewards.

12.4.2 Shakedown

12.4.2.1

Only crews that enrolled for the shakedown by the term given can take part in it (see Article 3 PROGRAMME). The fee at CZK 1,000 / € 35 must be settled at the receipt of the itinerary at the latest.



Autoklub Bohemia Sport v AČR
Sosnová 200, 470 01 Česká Lípa
IČ: 75057930, reg. č. 1558





12.4.2.2

Each person in the car during the shakedown who is not registered in the rally takes part in the shakedown on their own responsibility and at their own risk. The organizer is deprived of any responsibility for their participation. The competitor signing the shakedown entry form, states that they shall inform such a participant about their responsibility and possible safety risk. Such person, who participates in the shakedown, will be above 18 years, and the competitor takes the responsibility for observing these regulations. For the use of fire-resistant clothing, helmet and frontal head restraint (safety equipment of the crew) the same regulations are applied as to SS at the rally, and the correct use of this safety equipment is the competitor's responsibility. In case any failing in the safety equipment of a racing car is found out during the shakedown, the crew will not be allowed to continue the shakedown.

12.4.2.3

During the shakedown the competitors can use the track between the shakedown start and finish at Hrdlořezy for servicing racing cars, according to the organizers' instructions and with respect to the traffic signs.

12.4.2.4

A breach of these regulation for the shakedown will be reported to the Stewards.

12.5 Organization of the Service Parks

12.5.1

The SPR regulations apply to the Service Zone and Service Park (especially Article 2.16 and 48 till 51) and hereby SR.

12.5.2

The Service Park at 11th Gate – Škoda Auto will be opened (see the Article 3 PROGRAMME). The area of 100 m² will be reserved for the FIA and ASN priority drivers, 80 m² for other crews. The assigned place will be announced to crews at handing in of the road book and the layout of the situation will be published on the organizer's website at www.rallybohemia.cz. Extra demands have to be delivered in written form to the organizer (see the Article no. 3 PROGRAMME).

12.5.3

Only one assistance car "SERVICE A" and one assistance car "SERVICE B" per crew can enter the Service Park (see the Article 4.4.2). Competitor can buy a maximum of two other car labels (AUXILIARY) for CZK 250 / € 10, which can be used for parking on the place reserved near the Service Park. This marking of team cars as well as the need of marking other cars according to the competitors' consideration (e.g. manager, guest), will be ordered in the form "Special requirements in the service park". Transport vehicles will be parked outside the service park in the area specified.



Autoklub Bohemia Sport v AČR
Sosnová 200, 470 01 Česká Lípa
IČ: 75057930, reg. č. 1558





12.5.4 Allowed Speed in the Service Park

The maximum speed of 30 km/h is allowed in the whole Service Park, which applies to all cars.

12.5.5 Catering in the Service Area

If your team or any other company would like to have a catering for their guests in the service park, it must be settled with organizer by the entry forms closure at the latest. If this is failed, catering may be forbidden by HQ. Selling food and drinks in the service area without the organizer's permission is strictly forbidden.

12.5.6 Violations of the Service Park Rules

Violation of the Service Park rules (e.g. entry of other than marked cars, maximum speed in the service park, damage of the service zone surface - drilling holes for anchoring tents...) will be penalized by the Clerk of the Course up to CZK 5,000 / € 190. Serious infringements will be reported to the Stewards.

12.6 Official Time Used During the Rally

The official time throughout the event corresponds to the time signal broadcast by the Czech Radio 2 Station (Český rozhlas 2) tuned on frequency of 89.9 MHz and 87.6 MHz or on the phone number 14112.

12.7 Reconnaissance

12.7.1

The time of entry to SS = 55 - 50 minutes before the first car of Rally Bohemia Historic (in no case will any reconnaissance car be admitted on the SS track at a later point). Reconnaissance will not go SS Bondy. The reconnaissance will always go only before the first passage through each stage.

12.7.2

The reconnaissance has to be marked properly with the label provided by the organizer.

12.7.3

The reconnaissance car has to be equipped with GPS monitoring unit for reconnaissance rides of the crew, which it makes reconnaissance for.

12.7.4

The organizer must be given the crew name, the car type and brand, register number and phone number, on which the crew will be available for the whole competition.



Autoklub Bohemia Sport v AČR
Sosnová 200, 470 01 Česká Lípa
IČ: 75057930, reg. č. 1558





12.7.5

Each crew can have only one reconnaissance car.

12.7.6

The fee for a reconnaissance car is CZK 3,000 / € 120 due with the entry form.

12.7.7

Each reconnaissance crew will obtain a label on the car, 1 pc road book and preliminary plan of individual SS entry.

12.7.8

The organizer reserves the right not to allow reconnaissance cars to some SS due to superior power.

12.7.9

In the case of these rules breach the reconnaissance car will not be allowed to run the rest of stages.

13 OFFICIALS IDENTIFICATION

The Post-chiefs will be identified as follows:

Chief of SS:	green tabard
Chief of Safety officers:	red tabard
Chief of Control:	blue tabard
Road Marshals:	yellow tabard with radio point symbol
Safety Marshals:	orange tabard
Timekeepers:	yellow tabard with ČASOMĚŘIČ-TIMING label

14 CLASSIFICATION AND PRIZES

14.1 Classification

14.1.1 Classification of the Czech Rally Championship

- General classification
- Classes 2 up to 13
- Independent classification of 2WD cars
- Independent classification of R1B and R2B groups from classification of classes 9, or 6
- The best lady crew
- The best mixed crew
- Juniors up to 27 years



Autoklub Bohemia Sport v AČR
Sosnová 200, 470 01 Česká Lípa
IČ: 75057930, reg. č. 1558





14.1.2 Independent Classifications of individual legs of Rally Championship of the Czech Republic

- General classification
- Classes 2 to 13
- Independent classification of R1B and R2B groups from classification of classes 9, or 6
- Standalone classification of 2WD cars

14.2 Prizes

The prizes will be awarded after arriving into the finish (see the Article no. 12.2) regarding the unofficial classification list. The ownership will be confirmed after the publishing of the official final results. The prizes will be awarded only when in given classification (group / class) compete at least 4 crews. Should the number be lower only the prize for 1st position will be awarded.

14.2.1 Total order at the rally finish

- cups for 1st – 3rd place of Rally Bohemia
- cups for 1st – 3rd place in Rally Championship of the Czech Republic within Rally Bohemia

14.2.2 Classes 2 to 13

- cups for 1st – 3rd place

14.2.3 Independent classification of 2WD cars

- cups for 1st – 3rd place

14.2.4 Independent classification of R1B and R2B groups from classification of classes 9, or 6

- cups for 1st - 3rd place

14.2.5 The best ladies crew

- cups for 1st place

14.2.6 The best mixed crew

- cups for 1st place

14.2.7 The best junior crew

- cups for 1st place





15 FINAL CHECKS AND PROTESTS

15.1 Final Checks

See paragraph No. 3 PROGRAMME

The complete and final check for the selected rally cars will be performed according to the written notification from the Clerk of the Course immediately after the arrival into the finish of the rally.

For each car a representative of the competitor and a maximum of two mechanics together with the driver, should he/she wish to, can attend to this check.

15.2 Protest Fee

CZK 10,000 / € 375

Should the protest require dismantling and reassembling of different parts of a car, the claimant must pay an additional deposit, which will be determined by the Stewards.

15.3 Appeal Fee

National (to ASN): CZK 20,000 / € 750

Petr Pavlát

Clerk of the
Course



Autoklub Bohemia Sport v AČR
Sosnová 200, 470 01 Česká Lípa
IČ: 75057930, reg. č. 1558





APPENDIX 1: SCHEDULE

Saturday 11th July 2015 / Sobota 11. 7. 2015 LEG 1 / 1. ETAPA

SS/RZ TC/ČK	Location Místo	SS dist. RZ délka	Liaison dist. Trať bez RZ	Total dist. Spoj. úsek	Target time Jízdní doba	First car due Čas 1. jezdce
Ceremonial START - Staroměstské náměstí / Staroměstské Square - Pátek / Frid.						20:00
1	Mladá Boleslav - Gate 7 - Start rally					14:55
SS1 Bondy						2,35
1A	Regrouping IN		1,40	3,75	0:14	15:14
Regrouping (Gate 11) - Přeskupení						0:10
1B	Regrouping OUT					15:24
2	Sychrov		32,18	32,18	0:32	15:56
SS2 Sychrov I.						19,58
Refuel RZ 1 (Rychnov)						
Distance to next refuel (Mladá Boleslav)						22,11 79,69 101,80
3	Desná		22,22	41,80	0:59	16:58
SS3 Šumburk I.						16,29
4	Dupanda		18,66	34,95	0:45	17:46
SS4 Bzí I.						5,82
4A	Regrouping IN		39,88	45,70	0:50	18:39
Regrouping (Gate 11) - Přeskupení						0:30
4B	Regrouping OUT Service IN					19:09
Service A (Mladá Boleslav)						(44,04) (114,34) (158,38) 0:30
4C	Service OUT					19:39
Refuel RZ 2 (Gate 11)						
Distance to next refuel (Rychnov)						19,58 33,78 53,36
5	Sychrov		32,71	32,71	0:45	20:24
SS5 Sychrov II.						19,58
Refuel RZ 3 (Rychnov)						
Distance to next refuel (Mladá Boleslav)						22,11 79,69 101,80
6	Desná		22,22	41,80	0:59	21:26
SS6 Šumburk II.						16,29
7	Dupanda		18,66	34,95	0:45	22:14
SS7 Bzí II.						5,82
7A	Parc Ferme IN		39,88	45,70	0:50	23:07
7B	Parc Ferme OUT - Flexi Service IN					
Flexi Service B (Mladá Boleslav)						(41,69) (113,47) (155,16) 0:45
7C	Flexi Service OUT - Parc Ferme IN					
All cars must be returned to Parc Ferme no later than						1:40

Sec. 1

Section 2

Section 3

Day 1 totals

85,73 227,81 313,54

27,34%



Autoklub Bohemia Sport v AČR
Sosnová 200, 470 01 Česká Lípa
IČ: 75057930, reg. č. 1558





Sunday 12th July 2015 / Neděle 12. 7. 2015

LEG 2 / 2. ETAPA

SS/RZ TC/ČK	Location Místo	SS dist. RZ délka	Liaison dist. Trať bez RZ	Total dist. Spoj. úsek	Target time Jízdní doba	First car due Čas 1. jezdce
7D	Parc Ferme OUT - Service IN					9:15
Service C (Mladá Boleslav)		(00,00)	(00,00)	(00,00)	0:15	
7E	Service OUT					9:30
Refuel RZ 4 (Gate 11)						
Distance to next refuel (Mladá Boleslav)		32,96	41,10	74,06		
8	Bezdědice		22,18	22,18	0:35	10:05
SS8	Lobeč I.	11,96				10:08
9	Skalsko		7,36	19,32	0:25	10:33
SS9	Víneč I.	15,98				10:36
10	Mladá Boleslav - airport		8,64	24,62	0:32	11:08
SS10	Staroměstská I.	5,02				11:11
10A	Regrouping IN		2,92	7,94	0:19	11:30
Regrouping (Gate 11) - Přeskupení					0:30	
10B	Regrouping OUT Service IN					12:00
Service D (Mladá Boleslav)		(32,96)	(41,10)	(74,06)	0:30	
10C	Service OUT					12:30
Refuel RZ 5 (Gate 11)						
Distance to finish (Mladá Boleslav)		32,96	38,30	71,26		
11	Bezdědice		22,18	22,18	0:35	13:05
SS11	Lobeč II.	11,96				13:08
12	Skalsko		7,36	19,32	0:25	13:33
SS12	Víneč II.	15,98				13:36
13	Mladá Boleslav - airport		8,64	24,62	0:32	14:08
SS13	Staroměstská II.	5,02				14:11
13A	Finish TC and Holding Area (STOP SS13)		0,12	5,14	0:10	14:21
Podium Ceremony - Staroměstské náměstí / Staroměstské Square						14:45

Section 4

Section 5

Day 2 totals	65,92	79,40	145,32	45,36%
---------------------	--------------	--------------	---------------	---------------

TOTALS OF THE RALLY					
Leg	SS	SS	Liaison	Total	%
1	7	85,73	227,81	313,54	27,34%
2	6	65,92	79,40	145,32	45,36%
Overall Totals	13	151,65	307,21	458,86	33,05%



Autoklub Bohemia Sport v AČR
 Sosnová 200, 470 01 Česká Lípa
 IČ: 75057930, reg. č. 1558





APPENDIX 2: RECONNAISSANCE SCHEDULE

9th July 2015

	SS Lobeč, Vinec, Sychrov, Šumburk, Bzí, Shakedown		SS Staroměstská		SS Bondy	
st. no.	start time	end time	start time	end time	start time	end time
1 - 40	17:45	21:45	21:45	23:15	23:45	0:45
41 -	18:00	22:00	22:00	23:30	0:00	1:00

10th July 2015

	SS Lobeč, Vinec, Shakedown		SS Sychrov, Šumburk, Bzí	
st. no.	start time	end time	start time	end time
1 - 40	8:00	13:00	12:00	17:30
41 -	8:30	13:30	12:30	18:00



APPENDIX 3: COMPETITORS' RELATIONS OFFICERS

Basic duties and function of the Competitors' Relations Officers are given in Appendix 2 of the General Rules for the FIA Rally Championships.

The competitors' relations officers are:



Zdeněk Bělák

+420 602 530 321



Jakub Hofbauer

+420 777 306 344



Pavel Konečný

+420 774 594 008

Friday 10th July 2015, Mladá Boleslav

18:30 – 19:30 Administrative Check
21:00 – 22:00 Ceremonial Start

Dům kultury
Staroměstské náměstí

Saturday 11th July 2015, Mladá Boleslav

7:00 – 11:00 Scrutineering
14:45 – 17:00 Rally Start (TC1)
18:00 – 21:00 Regrouping (TC4A)
22:30 – 01:40 Parc Fermé (TC4A)

Škoda Auto Gate 11
Škoda Auto Gate 7
Škoda Auto Gate 11
Škoda Auto Gate 11

Sunday 12th July 2015 Mladá Boleslav

9:30 – 11:00 Start Leg 2(TC7D)
11:15 – 13:30 Regrouping (TC10A)
14:00 – 16:30 Rally Finish (TC13A)
16:15 – 16:45 Preliminary Final Results Announcement

Škoda Auto Gate 11
Škoda Auto Gate 11
Staroměstské náměstí
Dům kultury



Autoklub Bohemia Sport v AČR
Sosnová 200, 470 01 Česká Lípa
IČ: 75057930, reg. č. 1558





APPENDIX 4: START NUMBERS AND ADVERTISEMENT

The organizer reserves the right to the blank places on the car body as shown below:

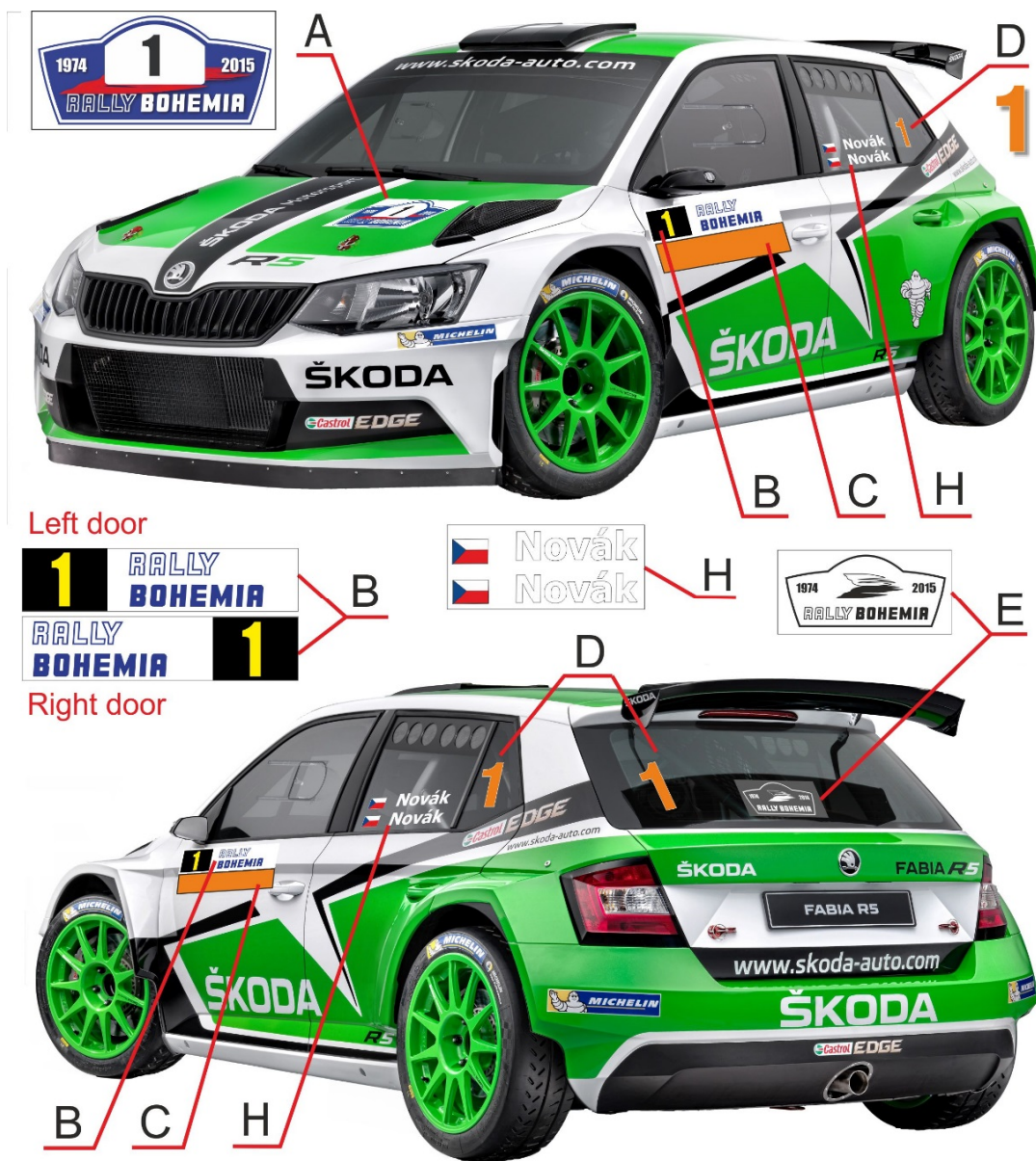

Compulsory advertising

- A – Rally plates - shield
- B – Competition numbers

- RALLY BOHEMIA
- RALLY BOHEMIA

Optional advertising proposed by the organizer

- C – Advertisement (67 x 20 cm)
- H – ŠKODA, GLOBAL ASSISTANCE, MOGUL



Autoklub Bohemia Sport v AČR
 Sosnová 200, 470 01 Česká Lípa
 IČ: 75057930, reg. č. 1558





APPENDIX 5: DRIVERS' SAFETY EQUIPMENT REGULATION

1. Safety helmets

According to Article No. 1 Chapter III Appendix L of FIA ISC all drivers and co-drivers have to wear the safety helmet on all special stages and which must correspond to the FIA standards and listed in the FIA technical list no. 25 (www.fia.com).

2. Fireproof overall

According to Article No. 2 chapter III appendix L of FIA ISC all drivers and co-drivers have to wear the overall, long sleeves underwear, face guard, socks, shoes and gloves on all special stages and which must be homologated according to FIA standard 8856-2000 and listed in the FIA technical list No. 27 (usage of gloves is for co-drivers optional).

3. Head support system (FHR, for example HANS)

According to Article No. 3 chapter III appendix L of FIA ISC all drivers and co-drivers have to wear approved head support system on all special stages and which must be homologated according to FIA norm No. 8858. All homologated FHR systems are listed in FIA technical list no. 29 and should be used only with the elements approved by FIA according to Article 3.2 Chapter III Appendix L FIA ISC.

4. Security seat belts

Drivers and co-drivers have to be fastened in the seat during the drive on special stages and on track using security seat belts corresponding with the specifications of Appendix J for corresponding car (Article No. 4 Chapter III Appendix L of FIA ISC). According to Article No. 253/6.1 Appendix J of FIA ISC all cars have to be equipped with security seat belts with the lock type "P" (push-button) with press mechanism. In the car there must be two knives within easy reach for both the driver and co-driver sitting fastened in their seats.

5. Use Specification

The use of the driver's safety equipment is specified in more detail in NSC in chapters E.

6. Driver's safety equipment card

During the scrutineering the competitor has to hand in the filled-out Driver's safety equipment card, which is available online at www.autoklub.cz/fasacr in the folder named forms or at the organizer's web sites www.rallybohemia.cz, where it is a part of the scrutineering card.



Autoklub Bohemia Sport v AČR
Sosnová 200, 470 01 Česká Lípa
IČ: 75057930, reg. č. 1558





APPENDIX 6: GPS ONI® TRACKING SYSTEM

1. General provisions

During the rally all competition cars have to be obligatorily equipped with the ONI® tracking system. The ONI® tracking system is in possession of the Autoklub of the Czech Republic and it is hired to the competitors for a single fee at CZK 100/unit and CZK 300/unit bracket unless it has already been installed in the car. The return of this unit is guaranteed by the driver's licence or a deposit of CZK 1,000 left at the system provider. The system provider will return the licence or deposit after the unit is returned. Eventual destruction, non-return or damage of the unit has to be paid for by the competitor to the provider in accordance with the approved price list, otherwise the driver's licence, or deposit, will not be returned.

2. Distribution of the ONI® tracking systems

To install the ONI® tracking system it is necessary to fit a tracking unit bracket assembly firmly into each monitored car before the rally scrutineering. The bracket assembly contains the following parts:

- Tracking unit bracket with cables and fitting accessory
- 2 aerials (roof and inner)
- Control features:
 - Button to cancel the alarm / call for help/confirmation of yellow flag
 - LED indicator / signalling yellow flag

The above mentioned parts will be given by the ONI® unit provider to all regular rally participants in the Czech Republic to be permanently installed in the.

Cars of foreign competitors and other cars with sporadic starts will receive the bracket assembly right before the event as a version for a single use. The competitors will be informed thereof at administrative checks.

After the car arriving at the area before the scrutineering check, the system provider will check the bracket assembly, attach the tracking unit and test the system.

At the end of the rally or after withdrawal from the rally the tracking units (or the whole tracking system) have to be returned to the system provider. This usually happens in the service park area in front of the rally finish.

3. Installation of the bracket assembly in the car

3.1 To fit the tracking unit bracket, the roof and the inner aerials, and the individual control features, it is necessary for the competitor to meet exactly the Installation Manual of the manufacturer (the NAM System, a.s.), and to keep the unit in good condition, and to protect it against damage and contamination (especially the connectors) at all times.

3.2 Foreign and one time rally participants will receive a modified unit equipped with magnetic roof aerial and with control features which are contained in one common. The competitor has to choose a suitable place to fit the control unit within the reach of both crew members and he/she has to prepare everything for its installation.



Autoklub Bohemia Sport v AČR
Sosnová 200, 470 01 Česká Lípa
IČ: 75057930, reg. č. 1558





4. The unit operation during rally

To operate the unit, the crews have to meet all instructions as mentioned in the User's Manual issued by the manufacturer (the NAM System, a.s.).

Operation during rally (after installation of unit):

Operation during events on SS:

- Accident (detection of crash)
 - Alarm is generated automatically immediately after crash and hooter sounds
 - Alarm can be cancelled by short push of button (1 second) in case the help is not necessary
- Stop (over 30 seconds)
 - Hooter will sound after 30 seconds
 - Alarm can be cancelled by short push of button (1 second) in case the help is not necessary
 - Cancellation can be made with a short push right after the stop
- Request for help
 - In cases when immediate help is needed on SS (e.g. health danger, etc.)
 - Request for help can be made by a long push of button (3 seconds) - sending the message will be confirmed by the hooter sound
- Yellow flag
 - in case the yellow flag is hung on SS, the rally organizer will send selected crews an impuls to switch on the yellow LED diodes installed in the visual angle of the crew. The crew shall confirm acceptance of the yellow flag with a short push of the button (1 sec). The yellow diode will go out.

Attention: Failure of cancelling the alarm is considered to be the request for help!!!

5. Speed limit monitoring at recce

During reconnaissance rides the crew is obliged to keep to the Traffic rules of the Czech Republic. Failure to do so, mainly maximum speed exceeding, will be monitored by the track ONI® System. This monitoring does not exclude other check, e.g. from the side of the Police of the Czech Republic, including standard penalties. The tracking ONI® System monitors speed on-line at any time of the recce.

Each crew will pick up ONI® System monitoring device together with Road Book. The driver's licence or a deposit at CZK 1,000 will serve as a guarantee. It is to be passed over to the tracking ONI® System provider after recce.

The system installation and usage during recce is compulsory for every crew in accordance with Article No. 3 of Programme.



Autoklub Bohemia Sport v AČR
 Sosnová 200, 470 01 Česká Lípa
 IČ: 75057930, reg. č. 1558





The following units are used for monitoring the speed at recce:

a) NCL11PP



In case NCL11PP units are used, the power supply connector must be plugged in the lighter socket in the car, which must be under voltage. After plugging the connector in the lighter socket, the switching of the unit is optically signalled on the unit by switching the red LED. This LED starts blinking after catching the signal. If the LED is not switched on after plugging the supply connector in the lighter socket, the power supply of the lighter socket has to be checked. At some cars the supply starts to function after turning the ignition key. If even after turning the ignition key there is no voltage in the lighter socket, the NCL11PP unit will not work.



Optical signalling of power supply:

Power supply OK, the unit is functional



Without power supply, the unit is non-functional



If the unit gets into the state of drive (change of GPS and accelerometer), it is optically signalled with lighting green LED.





b) NCL15

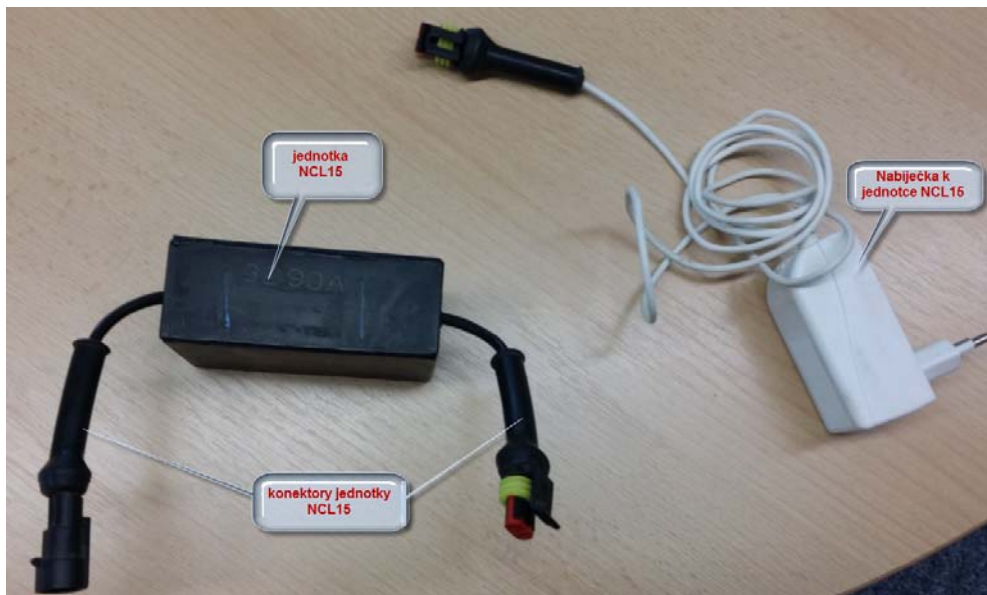

In case units NCL15 are used, both connectors of NCL15 unit have to be connected. After their connecting the unit starts working.



At these units also the level of charging is signalled:

- Unknown state (?)
- Discharged 0-20% (red)
- Discharging 20 - 70% (yellow)
- Charged 70 - 99% (green)
- Charged 100% (green + tick)



Failure to use the unit will result in penalization.



Every attempt to falsify, manipulate or otherwise interfere with the monitoring device assigned to the race car, or any other device blocking to record data will be reported to the sports chiefs who can impose penalties up to the refusing of start.

Decision on the seriousness of the offence and its recurrence lies within the authority of the Clerk of the Course. Exceeding speed limits shall result in penalties in accordance with Article 20.2 of SR.

6. Manuals and other Information

www.onisystem.cz/rally



Autoklub Bohemia Sport v AČR
Sosnová 200, 470 01 Česká Lípa
IČ: 75057930, reg. č. 1558

